

Limited Edition Woven Reed Handmade Bicycle Basket



- Designed by Wald and handmade by Jan Treesh, a Lexington, Kentucky artisan
- Individually numbered, dated and signed
- Handlebar mounts & basket supports made by Wald in Maysville, KY
- Approx. size 13" x 10" x 8 3/4" deep (each individual basket varies)

• See mounting instructions on back



Proudly Made in U.S.A.

Mfgr.No.33WR
©2015 Wald LLC
Rev.A, 5/14/2015



HANDMADE WOVEN BICYCLE BASKET with handle & mounting holder

- Basket easily removed for carrying.
- Fits 7/8", 1" & 1 1/4" diameter handlebars.
- Extended Mounting Holder allows clearance for shifters, brake levers & cables.

ASSEMBLY INSTRUCTIONS

- Loosely assemble ① brace onto two vertical side wires of ② holder with short screws. Preferably angle brace upward toward Stem as shown.
- Center holder and hang ③ holder top brackets over handlebar.
 - If mounting to a 7/8" handlebar use upper slot on the holder ③ top bracket and if to a 1" or 1-1/4" handlebar, use lower slot.
 - If clamping onto a 7/8" or 1" portion of handlebar, insert rubber spacer as shown with open end towards screw.
 - Loosely assemble two ④ handlebar clamps with long screws.
- Attach basket to holder.
 - Hold basket so ⑤ lock end of handle is toward holder.
 - Center basket with holder and insert lower basket frame wire over bottom hooks of holder as shown.
 - Raise handle upright and insert ⑤ lock end of handle through ⑦ slot at top of holder.
 - Lay handle flat to lock.
- Adjust holder ① brace vertically on holder side wires until basket is in proper position.
- Remove basket from holder
 - Raise basket handle upright.
 - Pull away from holder and lift basket from bottom hooks of holder.
- Tighten all holder fittings securely.

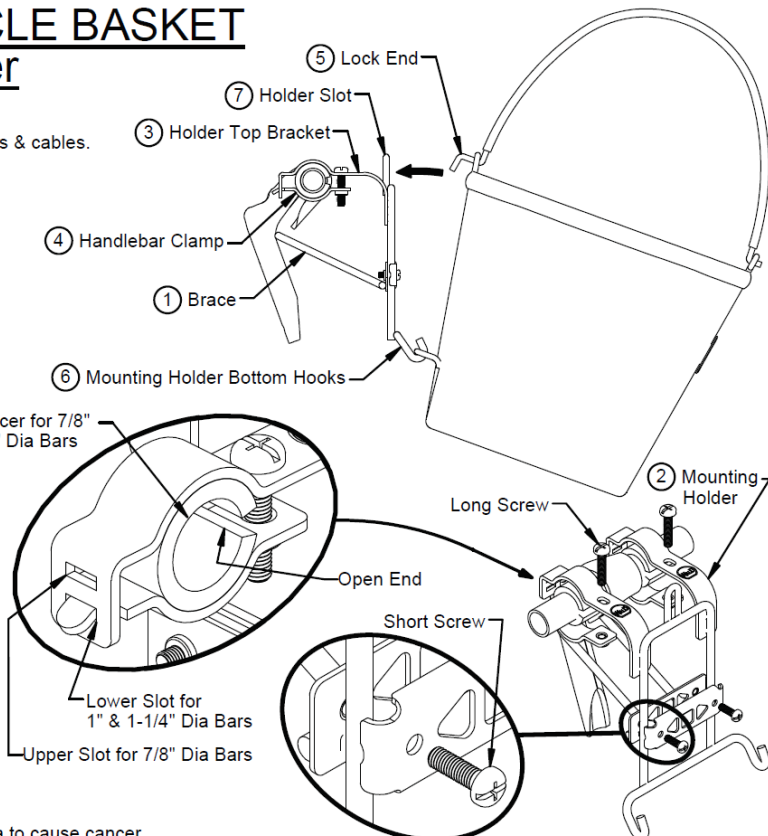

⚠ WARNING

- DO NOT overload basket.
- Overloading basket may cause difficulty in steering and/or loss of bicycle control which could result in injury.
- DO NOT use on bicycles with a carbon fiber handlebar.
- This product contains a chemical known to the state of California to cause cancer.